

INSTRUCTIONS TO ELEVATE YOUR SPACE

vogt

TABLE OF CONTENTS

▪ VE.2200/2210	WALL-MOUNTED TUB FILLER	3
----------------	-------------------------	---

Before you begin:

- Please take note of different standards and regulations that are dictated by your local plumbing codes. This product is certified in accordance with North American building codes.
- We insist that you use the services of a professional plumber with experience in the installation of similar fixtures.
- Ensure that the piping system is well secured to prevent rattling, vibration and banging noises caused by a water hammer. We also recommend that you use water hammer arrestors.
- Remove the cartridge and purge the water supply system for around 30 seconds. Then carefully reinstall the cartridge.
- After installation, check and ensure that there are no leaks.

Wall-mounted tub filler

**Tools and equipment
You will need:**

Estimated assembly time

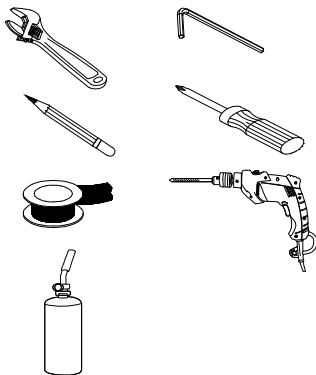

+/- 120 Min

Reference



Hot water



Cold water



Grease



Warning



Sealant tape

WALL-MOUNTED TUB FILLER

Valve Operating Diagram:

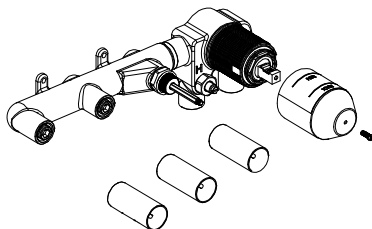
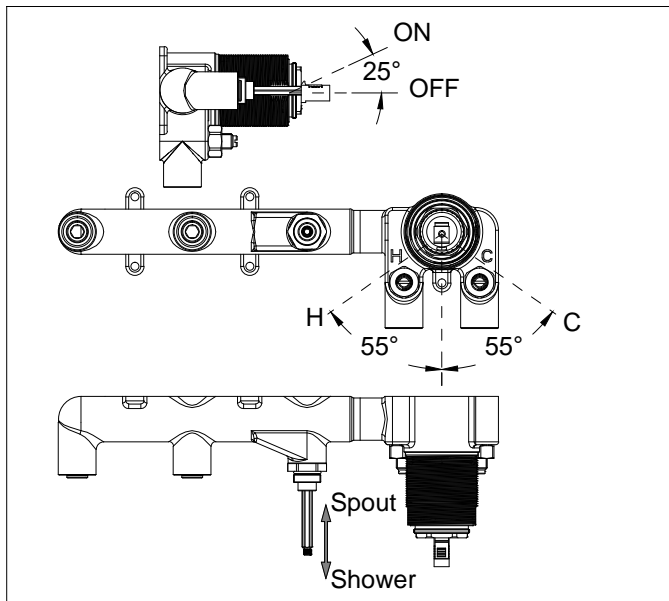

1

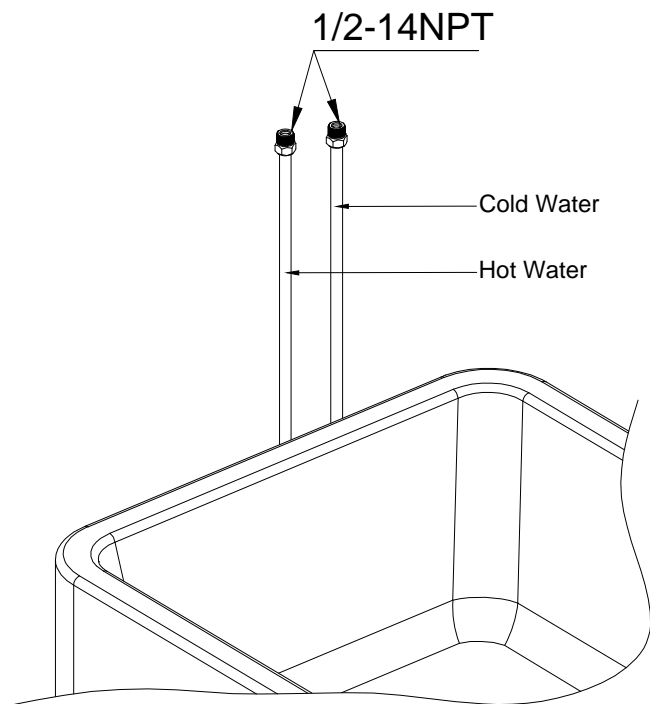

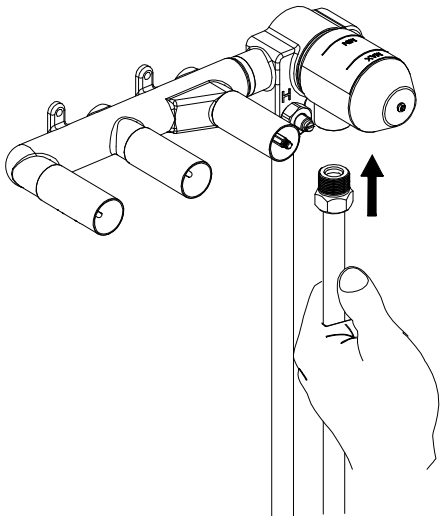
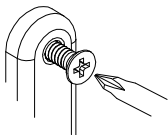
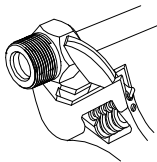
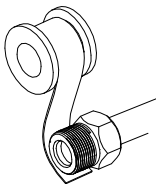
2**2a****2b**

3

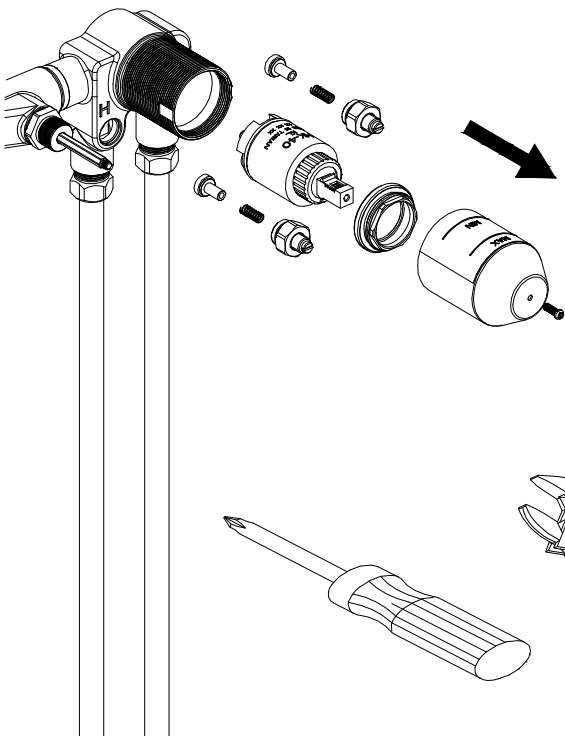

4

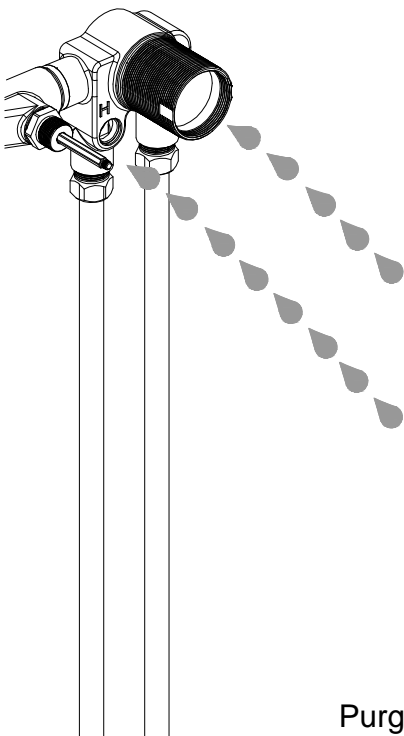

4b

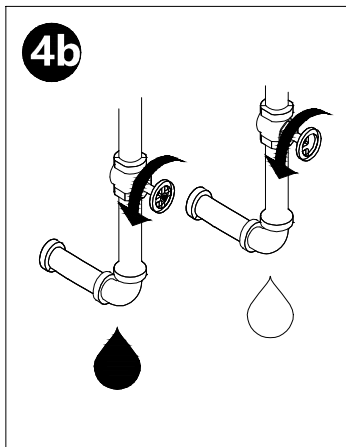

Purge the water supply system for around 30 seconds.

Reinstall the valve components into their original positions.

6

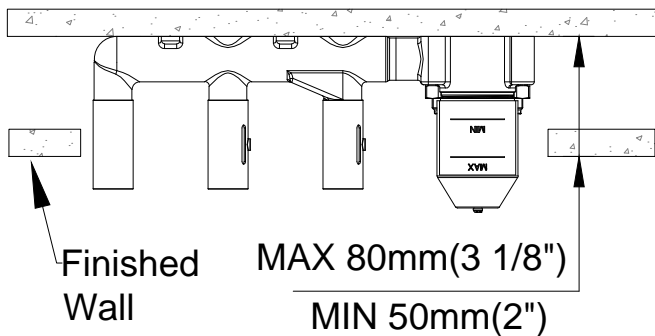
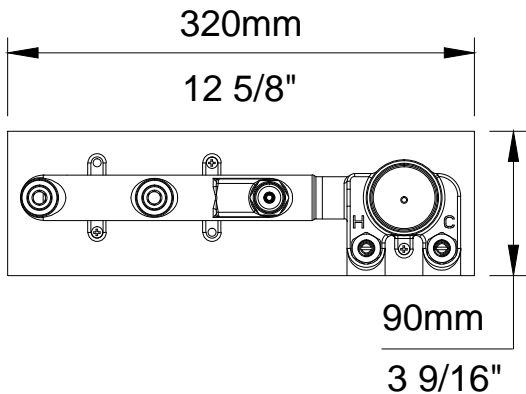



SCAN
TO LEARN
MORE

vogtindustries.com

Y5A1283X-A0