

INSTRUCTIONS TO ELEVATE YOUR SPACE

vogt

TABLE OF CONTENTS

• VE . 2100	TUB FILLER WITH RISERS	3
-------------	------------------------	---

Before you begin:

- Please take note of different standards and regulations that are dictated by your local plumbing codes. This product is certified in accordance with North American building codes.
- We insist that you use the services of a professional plumber with experience in the installation of similar fixtures.
- Ensure that the piping system is well secured to prevent rattling, vibration and banging noises caused by a water hammer. We also recommend that you use water hammer arrestors.
- Remove the cartridge and purge the water supply system for around 30 seconds. Then carefully reinstall the cartridge.
- After installation, check and ensure that there are no leaks.

Free-standing tub filler

**Tools and equipment
You will need:**

Estimated assembly time

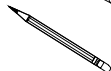
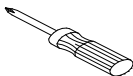

+/- 120 Min

Reference



Hot water



Cold water



Grease



Warning



Sealant tape

TUB FILLER WITH RISERS

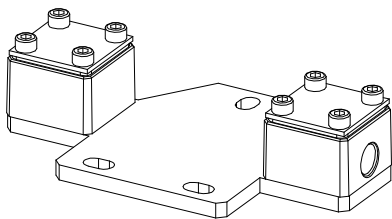

Rough-In

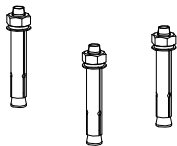

Expansion Screw

1

1a

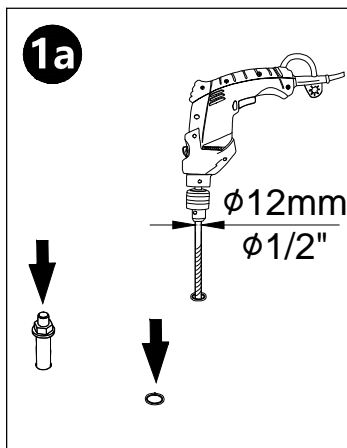

Sub Floor

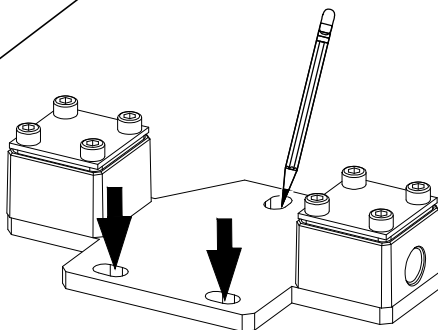

2

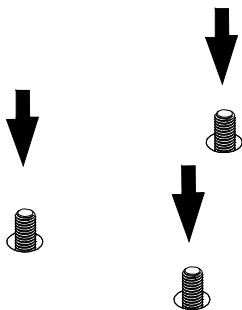
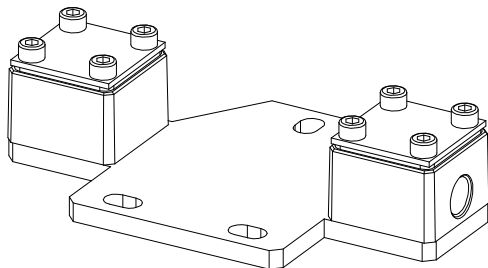

3

3a

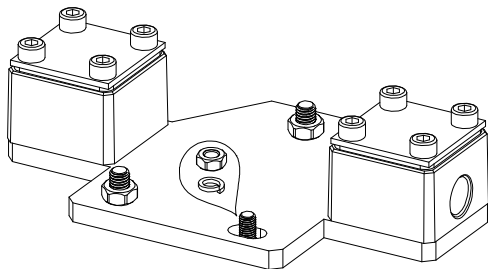
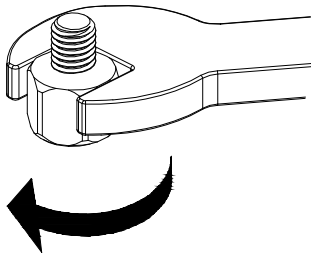

4

4a

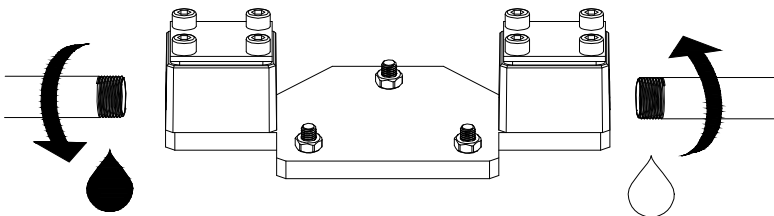
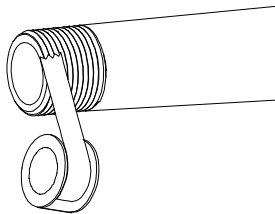

5

5a

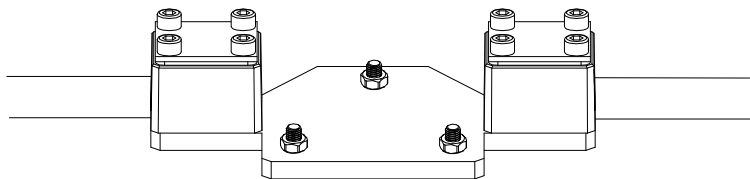
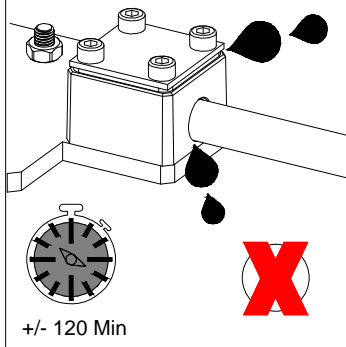

6

Finished
Floor

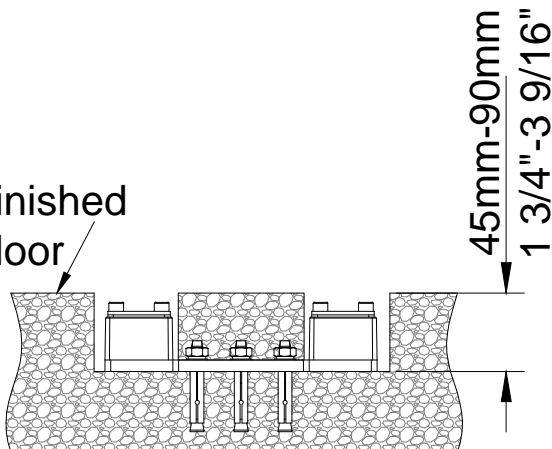

57mm-60mm
2 1/4"-2 3/8"

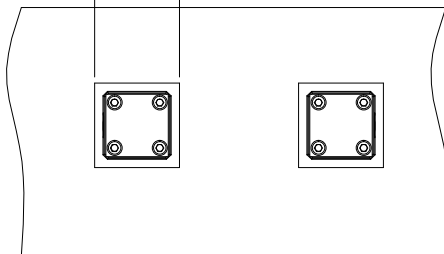



SCAN
TO LEARN
MORE

vogtindustries.com

Y5A1282X-A0