

Model Name: 2-WAY TH VALVE
Model No:VE.220

vogt

Pure **Quality**. Pure **Design**.

Before you begin:

- Please take note of different standards and regulations that are dictated by your local plumbing codes. This product is certified in accordance with North American building codes.
- We insist that you use services of a professional plumber with experience in the installation of similar fixtures.
- Ensure that the piping system is well secured to prevent rattling, vibration and banging noises caused by a water hammer. We also recommend that you use water hammer arrestors.
- Ensure that the interior of the water pipes is clean from debris, sand, solder and any other residue.
- Always remove cartridges and other valve components before welding. Purge the water supply system for around 30 seconds, and then carefully reinstall the cartridges.

Tools and equipment you will need:

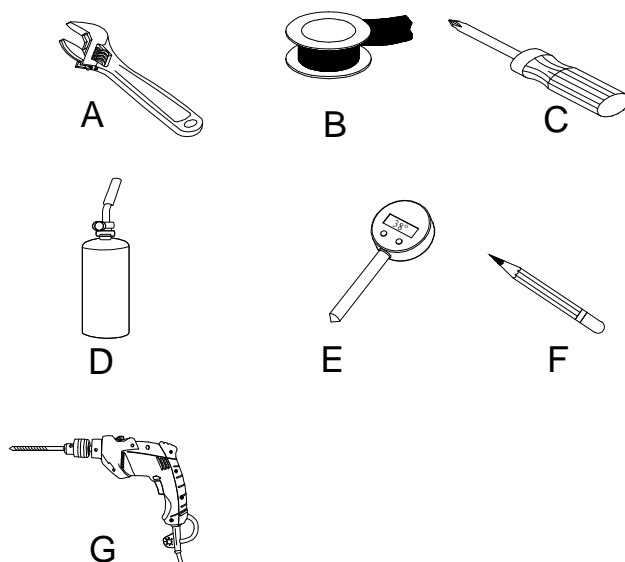

Sample Waterway diagram:

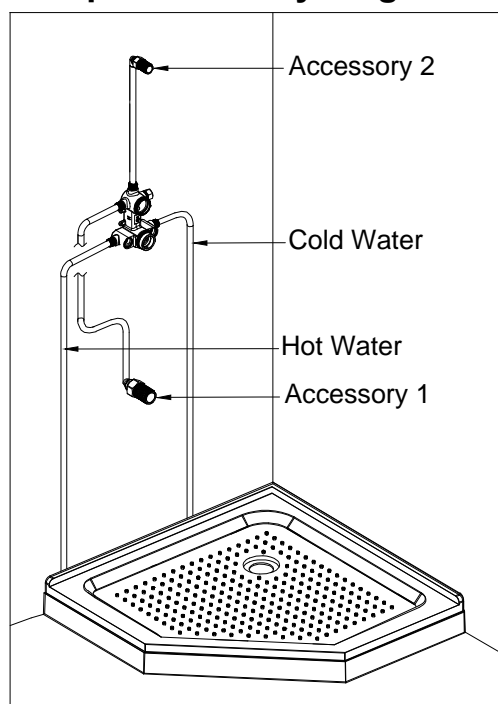

Valve Operating Diagram:

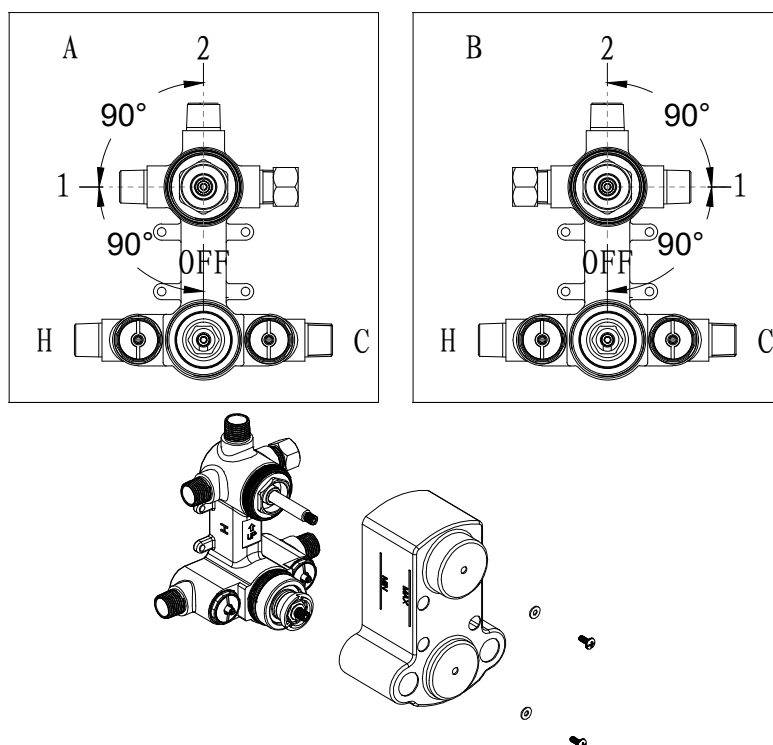

①

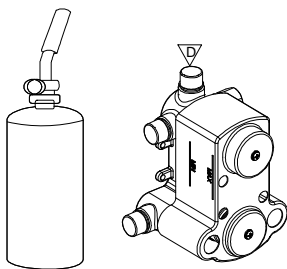

②

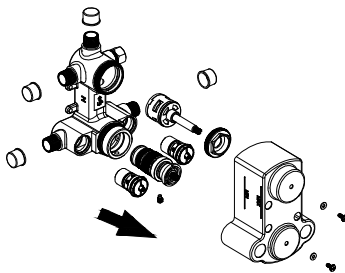

If welding is involved you must remove internal valve components prior to the welding. Please note the original position of the cartridge.

③

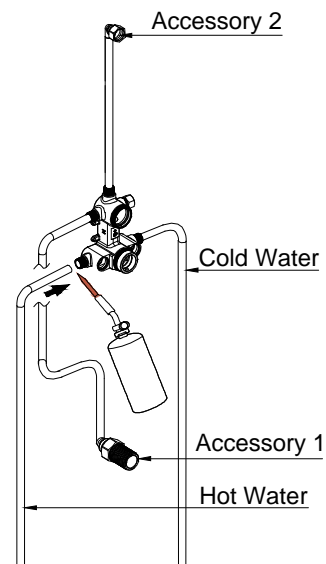

④

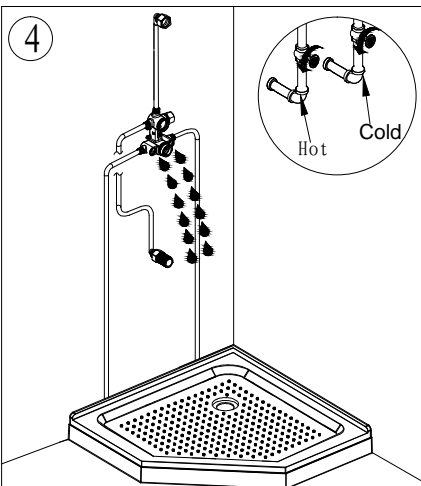

Once the welding is finished, purge the water supply system for around 30 seconds.

⑤

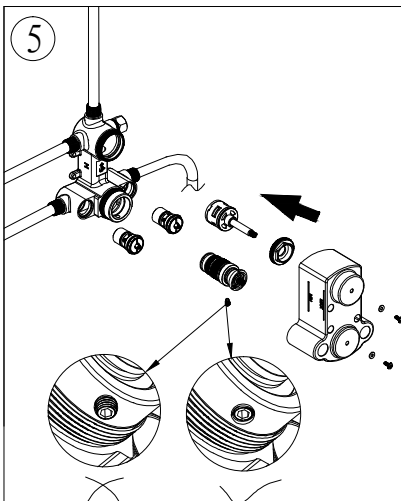

Reinstall the valve components into their original positions.

⑥

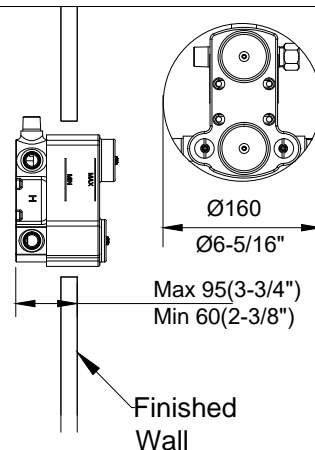

Make sure that the valve is installed in such a way that the finished wall is between the Max and Min marks.

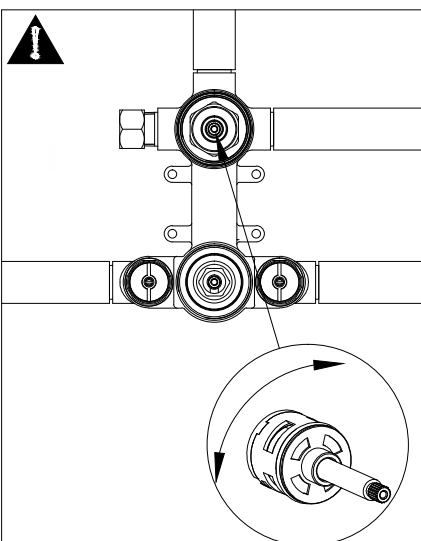

If using right side outlet, need to rotate the cartridge 180°.

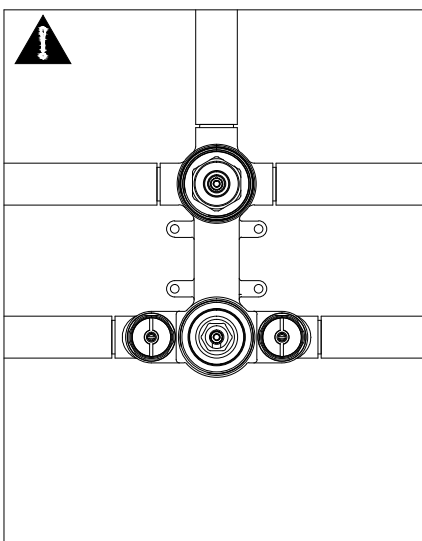

Note that if you need to use the capped port, then need to flip the diverter cartridge.