

KAPFENBERG

1-WAY PRESSURE BALANCED SHOWER SYSTEM

SET.AP.110.500

Components Included

- **VE.110** - Pressure balanced valve without diverter
- **TM.KG.110** - Trim for 1-way pressure balanced valve
- **BH.01.01** - 31½" sliding shower bar with hose and 4 function hand shower (HS.01.01)
- **EC.41.01** - Square elbow connector with ½" female NPT connection
- **TS.41.07** - Slip-on brass tub spout with diverter

Available Finishes

- Chrome (CC)
- Matte Black (MB)

(Model Pictured: Chrome)

Codes / Standards

- Uniform Plumbing Code (UPC®)
- ASME A112.18.1/CSA B125.1
- ASSE 1016

Warranty

- Limited lifetime warranty
(see full warranty for details)



KAPFENBERG PRESSURE BALANCED VALVE & TRIM

VT.KG.110

Description

- **VE.110** - 1/2" pressure balanced valve
- **TM.KG.110** - Trim for 1/2" pressure balanced valve
- 1 position

Flow Rate

- 5.5 gpm | 21 lpm | 60 psi

Cartridge

- CE.1440.PB - cartridge

Available Finishes

- Chrome (CC)
- Brushed Nickel (BN)
- Matte Black (MB)

(Model Pictured: Chrome)

Codes / Standards

- Uniform Plumbing Code (UPC®)
- ASME A112.18.1/CSA B125.1
- ASSE 1016

Warranty

- Limited lifetime warranty
(see full warranty for details)

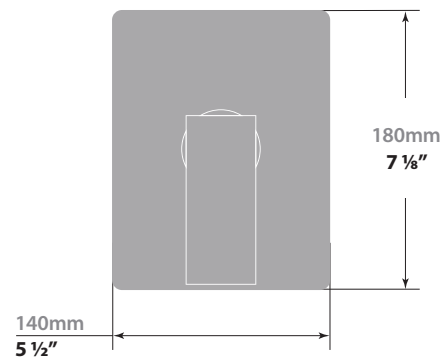

VE.110 - Pressure Balanced Valve Without Diverter

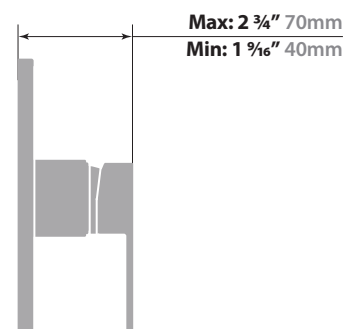
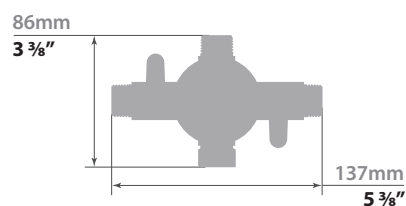
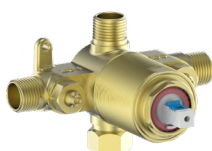

PRESSURE BALANCED VALVE WITHOUT DIVERTER

VE.110

Description

- Valve with pressure balanced cartridge
- ½" male NPT connections

Flow Rate

- 5.5 gpm | 21 lpm | 60 psi

Cartridge

- CE.1440.PB cartridge

Codes / Standards

- Uniform Plumbing Code (UPC®)
- ASME A112.18.1/CSA B125.1
- ASSE 1016

Warranty

- Limited lifetime warranty
(see full warranty for more details)

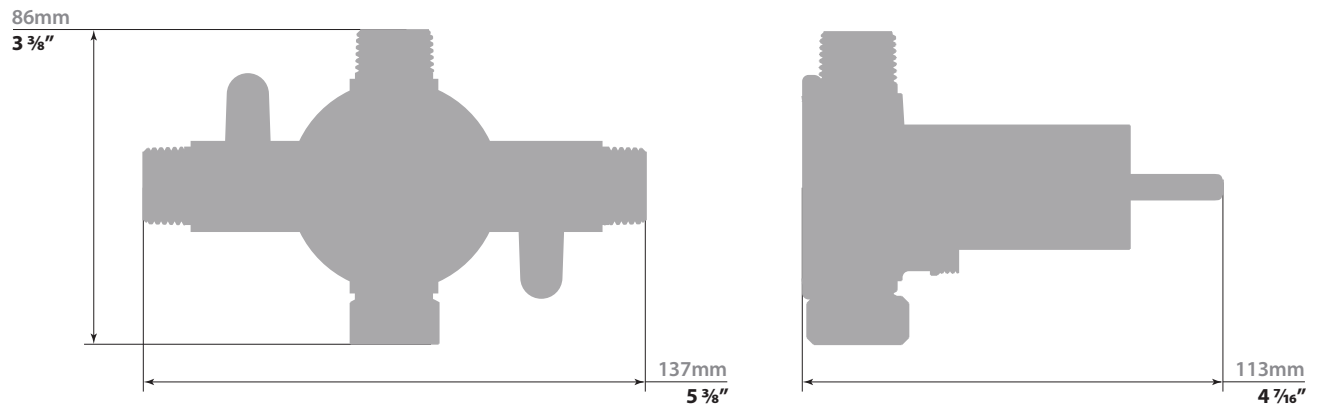
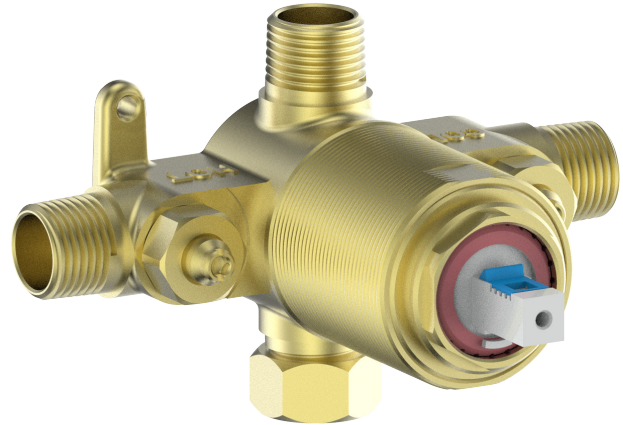

KAPFENBERG

SLIDING SHOWER BAR WITH HANDSHOWER

BH.01.01

Description

- **SB.01.31** - 31 ½" sliding shower bar
- **HE.150** - 59" hose
- **HS.01.01** - 1-function hand shower

Flow Rate

- 2 gpm | 7.6 lpm | 60 psi

Available Finishes

- Chrome (CC)
- Matte Black (MB)

(Model Pictured: Chrome)

Codes / Standards

- Uniform Plumbing Code (UPC®)
- ASME A112.18.1/CSA B125.1
- ASSE 1016

Warranty

- Limited lifetime warranty
(see full warranty for details)

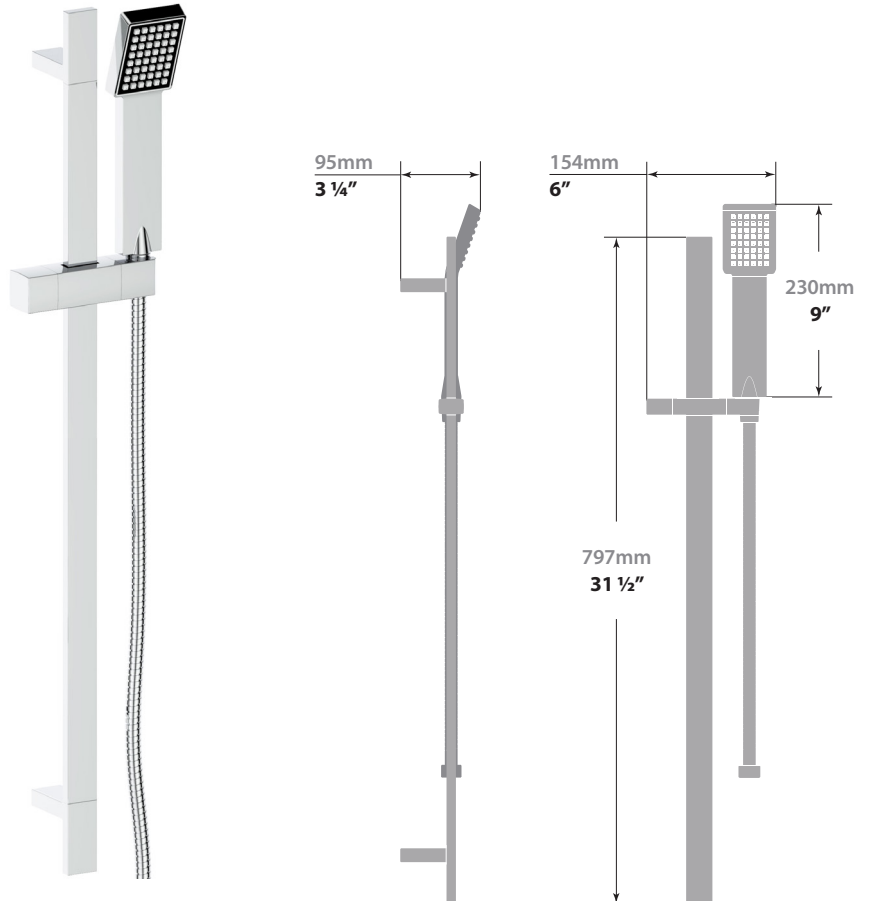

SQUARE WALL SUPPLY ELBOW

EC.41.01

Description

- Square elbow connector with ½" female NPT connection

Available Finishes

- Chrome (CC)
- Matte Black (MB)

(Model Pictured: Chrome)

Codes / Standards

- Uniform Plumbing Code (UPC®)
- ASME A112.18.1/CSA B125.1

Warranty

- Limited lifetime warranty (see full warranty for details)

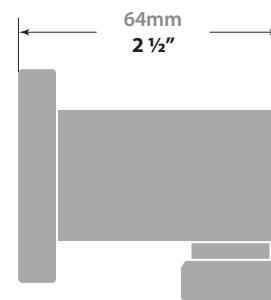
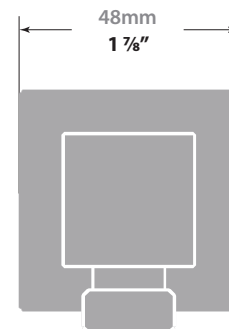
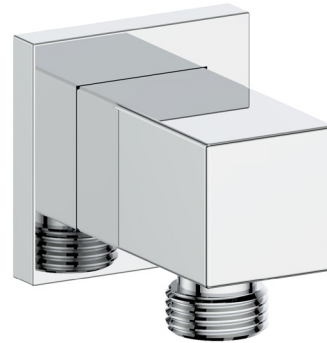

KAPFENBERG SLIP-ON TUB SPOUT WITH DIVERTER

TS.41.07

Description

- Brass tub spout with ½" slip-on connection

Available Finishes

- Chrome (CC)
- Brushed Nickel (BN)
- Matte Black (MB)

(Model Pictured: Chrome)

Codes / Standards

- Uniform Plumbing Code (UPC®)
- ASME A112.18.1/CSA B125.1
- ASSE 1016

Warranty

- Limited lifetime warranty (see full warranty for details)

